



For technical support contact D3@martin-audio.com

Bug fix update New product additions & configuration options

Introducing.....	1
Support for newer macOS versions	1
Support for macOS App menus	1
A more finely grained definition of speaker properties.....	2
Visual indication of horn orientation	6
Additions.....	6
New products.....	6
Changes.....	6
Renamed products.....	6
Fixes	7
Known Issues	7

Introducing

Support for newer macOS versions

We'd identified that the shading in the 3D venue was getting corrupted on versions of macOS Sonoma (14.7). In order to resolve this, we've updated essential graphics libraries in this release of Display 3. This does however have an effect on our capability to support running Display 3 on older versions of macOS.

This latest build has been tested successfully on the following versions, for both x86_64 (Intel) and arm64 (silicon M1 & M2) hardware types:

- Monterey (12.7)
- Ventura (13.7)
- Sonoma (14.7)

The following older versions of macOS can no longer be supported:

- Catalina (10.15)
- Big Sur (11.7)

Support for macOS App menus

Since the previous release of Display 3, version Beta 6 b50, a further refinement of the user experience for users running macOS has been added – The Display 3 Menu Bar has been moved to the macOS ‘App’ Menu location, at the top of the screen, next to the Apple menu. This should greatly facilitate the workflow for macOS users and help them locate operations more quickly & easily.

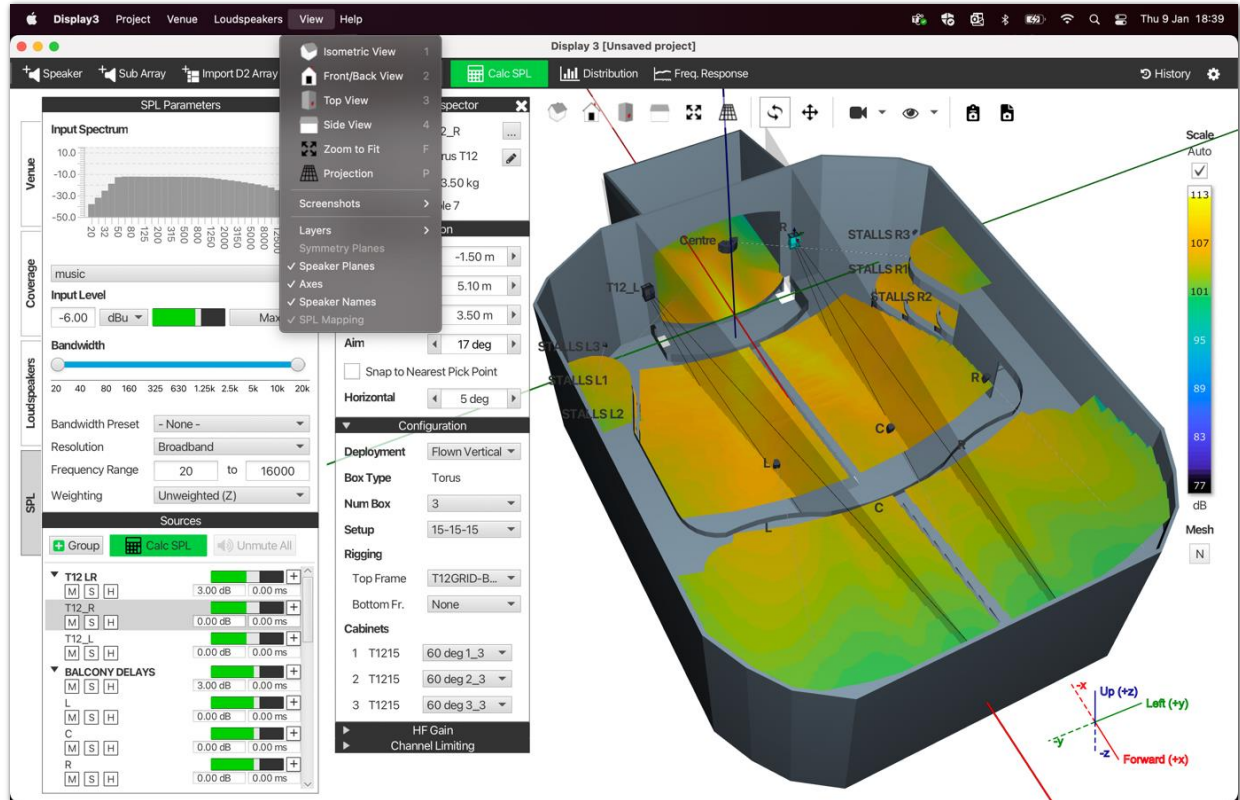

A more finely grained definition of speaker properties

- *Orientation, Preset & Transformer*

- A40

Speaker Inspector

Name

A40 L1

Type

A40

Orientation

Portrait

Preset

A40 FR

Transformer

☐

Weight

1.75 kg

Position

X

0.00 m

Y

0.00 m

Z

2.00 m

Aim

0 deg

Horizontal

0 deg

Channel Limiting

- *Preset, Transformer & Config*

- A55

Speaker Inspector

Name

A55 L1

Type

A55

Preset

A55 FR

Transformer

☐

Config

A55 Portrait

Weight

2.21 kg

Position

X

0.00 m

Y

0.00 m

Z

2.00 m

Aim

0 deg

Horizontal

0 deg

Channel Limiting

- **Preset**

- FP4

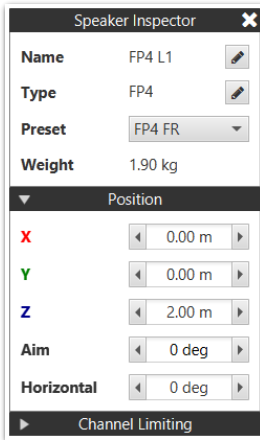

Speaker Inspector

Name: FP4 L1

Type: FP4

Preset: FP4 FR

Weight: 1.90 kg

Position

X: 0.00 m

Y: 0.00 m

Z: 2.00 m

Aim: 0 deg

Horizontal: 0 deg

Channel Limiting

- **Preset & Config**

- THV
- THH

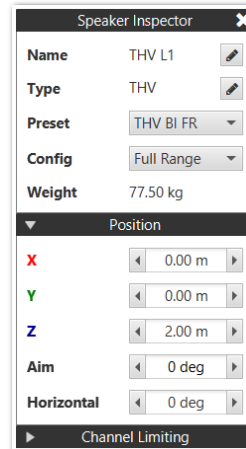

Speaker Inspector

Name: THV L1

Type: THV

Preset: THV BI FR

Config: Full Range

Weight: 77.50 kg

Position

X: 0.00 m

Y: 0.00 m

Z: 2.00 m

Aim: 0 deg

Horizontal: 0 deg

Channel Limiting

- **Orientation replacing the Config property:**

- SX110
- SX210
- SX112
- SX212

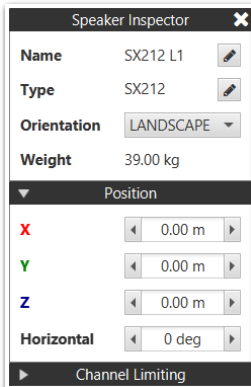

Speaker Inspector

Name: SX212 L1

Type: SX212

Orientation: LANDSCAPE

Weight: 39.00 kg

Position

X: 0.00 m

Y: 0.00 m

Z: 0.00 m

Horizontal: 0 deg

Channel Limiting

- **Orientation & Cardioid replacing the Config property:**

- SX118
- SX218
- SXH218

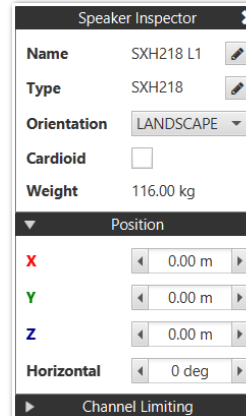

Speaker Inspector

Name: SXH218 L1

Type: SXH218

Orientation: LANDSCAPE

Cardioid: ☐

Weight: 116.00 kg

Position

X: 0.00 m

Y: 0.00 m

Z: 0.00 m

Horizontal: 0 deg

Channel Limiting

- **Preset & Config:**

- A80T

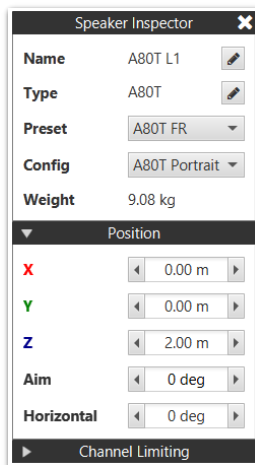

Speaker Inspector

Name: A80T L1

Type: A80T

Preset: A80T FR

Config: A80T Portrait

Weight: 9.08 kg

Position

X: 0.00 m

Y: 0.00 m

Z: 2.00 m

Aim: 0 deg

Horizontal: 0 deg

Channel Limiting

- **Orientation, Preset & Config:**

- THS

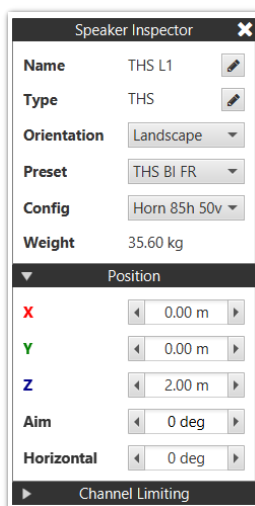

Speaker Inspector

Name: THS L1

Type: THS

Orientation: Landscape

Preset: THS BI FR

Config: Horn 85h 50v

Weight: 35.60 kg

Position

X: 0.00 m

Y: 0.00 m

Z: 2.00 m

Aim: 0 deg

Horizontal: 0 deg

Channel Limiting

- **Preset:**

- SX115

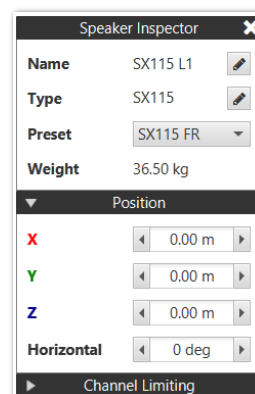

Speaker Inspector

Name: SX115 L1

Type: SX115

Preset: SX115 FR

Weight: 36.50 kg

Position

X: 0.00 m

Y: 0.00 m

Z: 0.00 m

Horizontal: 0 deg

Channel Limiting

- *Orientation & Preset:*

- SX215

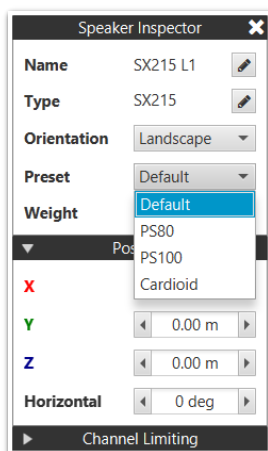

- *Config:*

- X115
- X118
- X218

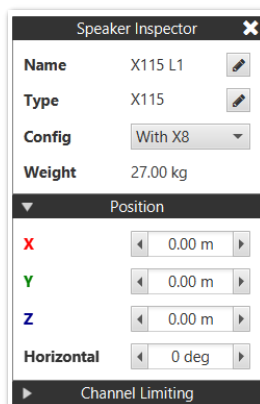

- Three new properties *Orientation*, *Preset* & *Config* now appear in the Speaker Inspector, for the following product:

- CDD5
- CDD6
- CDD8
- CDD10
- CDD12
- CDD15
- FP6
- FP8
- FP12
- FP15
- X8
- X10
- X12
- X15

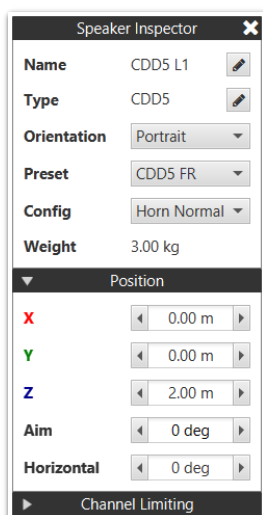

Visual indication of horn orientation

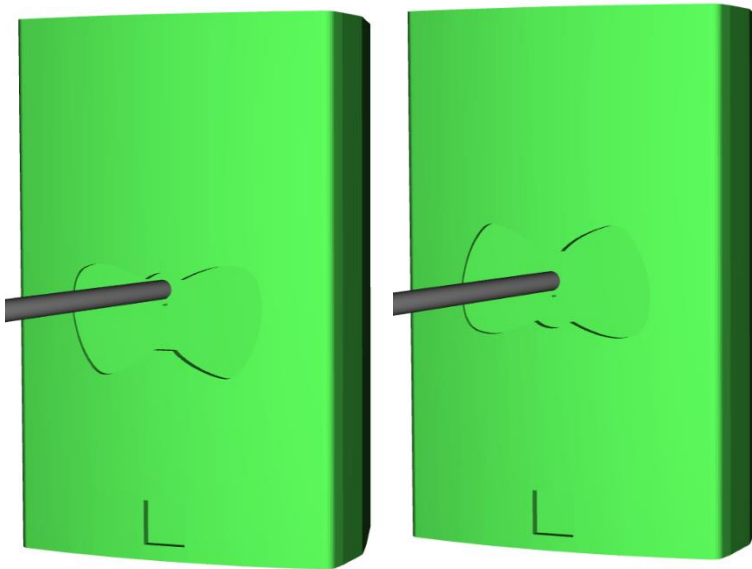

Additions

New products

The following new Martin Audio products have been added to Display 3:

- A80T
- THH
- THS

and the sub arrays:

- SX115
- SX215

Changes

- [D3-98] Support for older macOS versions Catalina (10.15) and Big Sur (11.7) has been discontinued entirely.
- [D3-98] Support for the newer macOS versions Ventura (13.7) & Sonoma (14.7) has been improved (graphics rendering).
- Display 3 Menu Bar moved to the macOS 'App' Menu location next to the Apple menu.
- New properties have been added to the Speaker Inspector for certain speakers. For details, please see above, under the section titled *A more finely grained definition of speaker properties*.
- New measurement data is available for all point source speakers (A40, A50, A80T, ACP55T, ACS55T, ACS55TS, ACS40T, C48T, C68T, C81T, THS, THV, X8, X10, X12, X15, XP12, XP15, FP4, FP6, FP8, FP12, FP15, CDD5, CDD6, CDD8, CDD10, CDD12, CDD15, CDDL8, CDDL12, CDDL15).

Renamed products

The following Martin Audio products have been renamed in Display 3:

- ACP-55T → ACP55T



- ACS-40TS → ACS40TS
- ACS-55T → ACS55T
- ACS-55TS → ACS55TS
- CDD 5 → CDD5
- CDD 6 → CDD6
- CDD 8 → CDD8
- CDD 10 → CDD10
- CDD 12 → CDD12
- CDD 15 → CDD15
- C4.8T -> C48T
- C6.8T -> C68T
- C8.1T -> C81T

Please note that this will not impact opening existing projects in Display 3, as loudspeaker names will be automatically updated on opening a project.

Fixes

- [D3-67 / D3-131] When changing speaker type in the Speaker Inspector, speaker name, group membership, input settings (e.g. gain and delay values, etc.) & symmetries are now preserved as far as this is possible.
- [D3-98] macOS 14 causing heavy shadows on surfaces.
- [D3-130] Duplicating of sub arrays is now possible.
- [D3-186] The default naming of duplicated speaker has been made more concise.
- [D3-189] When SPL parameters are changed, the SPL Distribution graph is no longer cleared – it remains in place and the title is updated to inform the user that the data is stale and the SPL should be recalculated to update the plot.
- [D3-194] On changing speaker type, the existing range & speaker type are now preselected in the "Choose Loudspeaker Type" dialog.
- [D3-197] Automated error reporting library updated to latest version.
- [D3-205] Venue faces & SPL Contour Map are now displayed more brightly at all viewing angles
- [D3-206] The *Choose Loudspeaker Type* Wizard was listing CCD-LIVE speakers together with the CDD products
- [D3-207] When changing the type of a single subwoofer using the Speaker Inspector, the single speaker was incorrectly converted to a subwoofer array
- [D3-208] After adding a new SX215 to a project, the orientation now defaults to landscape mode, similarly to all other subwoofers
- [D3-209] Missing cardioid configuration option added to the SX215 subwoofer

Known Issues

- There were no newly raised known issues at the time of writing.